

# PALOMINO FIELDS PLAT - DIVISION III

## A REPLAT OF TRACT 'A', PALOMINO FIELDS PLAT - DIVISION II

### A PORTION OF THE S 1/2 OF THE NW 1/4 OF SECTION 27, TOWNSHIP 18 NORTH, RANGE 18 EAST, W.M.

KITITAS COUNTY, WASHINGTON

SEE SHEET 3 OF 5  
MATCH LINE

LOT 1  
0.766 Acres  
More or Less  
N 62°00'00" E 306.00'  
P.L. W 306.00'  
15.00'

LOT 2  
0.821 Acres  
More or Less  
N 62°00'00" E 321.93'

NOTICE

This is a Major Plat and as such is not intended to show, nor does it purport to show, all easements and encumbrances.

APPROXIMATE LOCATION OF CENTERLINE OF TOWN DITCH / CANAL

REECER CREEK ROAD

N 00°05'25" W 1325.00'

### BASIS OF BEARINGS

The bearing for the East boundary line of the Northwest quarter of Section 27 equal Cruse & Nelson's bearing of South 00°15'36" East for the same line as shown on the FHA, U.S.D.A. property survey found under Kittitas County's Auditor File No. 199702200014

TRACT 'C', DIV. II

TRACT 'D', DIV. II

TRACT 'E', DIV. II

CURVE	RADIUS	DELTA	ARC	TANGENT	CHORD BEARING	CHORD
C1	157.04'	90°29'39"	248.03'	158.40'	S 45°14'49" W	223.94'
C2	470.00'	25°21'34"	208.02'	105.74'	S 12°40'47" E	205.33'
C3	20.00'	60°00'00"	20.94'	11.55'	S 58°00'00" E	20.00'
C4	80.00'	300°00'00"	418.88'	11.55'	S 62°00'00" W	80.00'
C5	20.00'	60°00'00"	20.94'	11.55'	N 02°00'00" E	20.00'
C6	530.00'	28°00'00"	259.01'	132.14'	N 14°00'00" W	256.44'
C7	217.04'	90°29'39"	342.79'	218.92'	N 45°14'49" E	308.26'
C8	187.04'	90°29'39"	295.41'	188.66'	S 45°14'49" W	265.65'
C9	500.00'	28°00'00"	244.35'	124.66'	S 14°00'00" E	241.92'
C10	200.00'	59°00'29"	205.98'	113.17'	S 57°30'14" E	196.99'
C11	470.00'	2°38'26"	21.66'	10.83'	N 26°40'47" W	21.66'
C12	470.00'	23°31'49"	193.02'	97.89'	N 13°35'39" W	191.67'
C13	470.00'	1°49'44"	15.00'	7.50'	N 00°54'52" W	15.00'
C14	233.00'	28°28'34"	115.80'	59.12'	S 16°53'27" E	114.61'
C15	233.00'	1°28'42"	6.01'	3.01'	S 31°52'05" E	6.01'
C16	967.00'	4°11'43"	70.61'	35.42'	S 30°30'34" E	70.79'
C17	512.52'	2°28'58"	84.83'	42.51'	S 23°40'14" E	84.73'
C18	512.52'	2°40'48"	23.97'	11.99'	S 17°35'20" E	23.97'
C19	533.00'	9°03'14"	84.22'	42.20'	S 20°46'33" E	84.14'

To West 1/4 Corner N 89°59'31" E 2643.42'

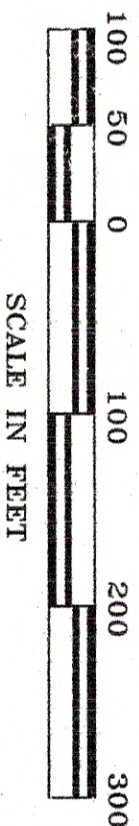

SCALE IN FEET

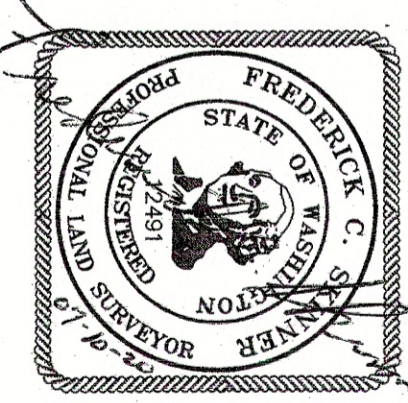

PL — Parcel boundary as contained in PROPERTY DESCRIPTION AS RESULT OF SURVEY

# — Note — See NOTES — Sheet 4 of 5

> < — Previously recorded information from Statutory Warrantly Deed found under Kittitas County's AFN 416766

{ } — Previously recorded information from Palomino Fields Plat - Div. II drawing as found under Kittitas County's AFN 201905210014

[ ] — Previously recorded information from Record of Survey drawing as found under Kittitas County's AFN 199702200014

< > — Previously recorded information from Record of Survey drawing as found under Kittitas County's AFN 199702200014

( ) — Previously recorded information from Preston Short Plat, Short Plat A-22, and shown on drawing as Kittitas Co. Short Plat No. 77-12, as found under Kittitas County's AFN 418140

[ ] — Previously recorded information from Record of Survey drawing as found under Kittitas County's AFN 199702200014

< > — Previously recorded information from Record of Survey drawing as found under Kittitas County's AFN 199702200014

[ ] — Previously recorded information from Record of Survey drawing as found under Kittitas County's AFN 199702200014

< > — Previously recorded information from Record of Survey drawing as found under Kittitas County's AFN 199702200014

[ ] — Previously recorded information from Record of Survey drawing as found under Kittitas County's AFN 199702200014

< > — Previously recorded information from Record of Survey drawing as found under Kittitas County's AFN 199702200014

[ ] — Previously recorded information from Record of Survey drawing as found under Kittitas County's AFN 199702200014

< > — Previously recorded information from Record of Survey drawing as found under Kittitas County's AFN 199702200014

[ ] — Previously recorded information from Record of Survey drawing as found under Kittitas County's AFN 199702200014

< > — Previously recorded information from Record of Survey drawing as found under Kittitas County's AFN 199702200014

[ ] — Previously recorded information from Record of Survey drawing as found under Kittitas County's AFN 199702200014

< > — Previously recorded information from Record of Survey drawing as found under Kittitas County's AFN 199702200014

[ ] — Previously recorded information from Record of Survey drawing as found under Kittitas County's AFN 199702200014

< > — Previously recorded information from Record of Survey drawing as found under Kittitas County's AFN 199702200014

[ ] — Previously recorded information from Record of Survey drawing as found under Kittitas County's AFN 199702200014

< > — Previously recorded information from Record of Survey drawing as found under Kittitas County's AFN 199702200014

[ ] — Previously recorded information from Record of Survey drawing as found under Kittitas County's AFN 199702200014

< > — Previously recorded information from Record of Survey drawing as found under Kittitas County's AFN 199702200014

[ ] — Previously recorded information from Record of Survey drawing as found under Kittitas County's AFN 199702200014

< > — Previously recorded information from Record of Survey drawing as found under Kittitas County's AFN 199702200014

[ ] — Previously recorded information from Record of Survey drawing as found under Kittitas County's AFN 199702200014

< > — Previously recorded information from Record of Survey drawing as found under Kittitas County's AFN 199702200014

[ ] — Previously recorded information from Record of Survey drawing as found under Kittitas County's AFN 199702200014

< > — Previously recorded information from Record of Survey drawing as found under Kittitas County's AFN 199702200014

[ ] — Previously recorded information from Record of Survey drawing as found under Kittitas County's AFN 199702200014

< > — Previously recorded information from Record of Survey drawing as found under Kittitas County's AFN 199702200014

[ ] — Previously recorded information from Record of Survey drawing as found under Kittitas County's AFN 199702200014

< > — Previously recorded information from Record of Survey drawing as found under Kittitas County's AFN 199702200014

**WESTERN PACIFIC ENGINEERING & SURVEY**

A TERRA DEVELOPMENT SERVICES CORPORATION  
1328 E. Hunter Place, Moses Lake, Washington  
T:(509)765-1023 F:(509)765-1298  
Services in Washington and Idaho

---

**LCU, INC.**

Surveyed by: LMH Scale 1" = 100'  
Drawn by: Tml/FCS Sheet 2 of 5  
Checked by: FCS Project No. 18146